

KING

HOME 805 N

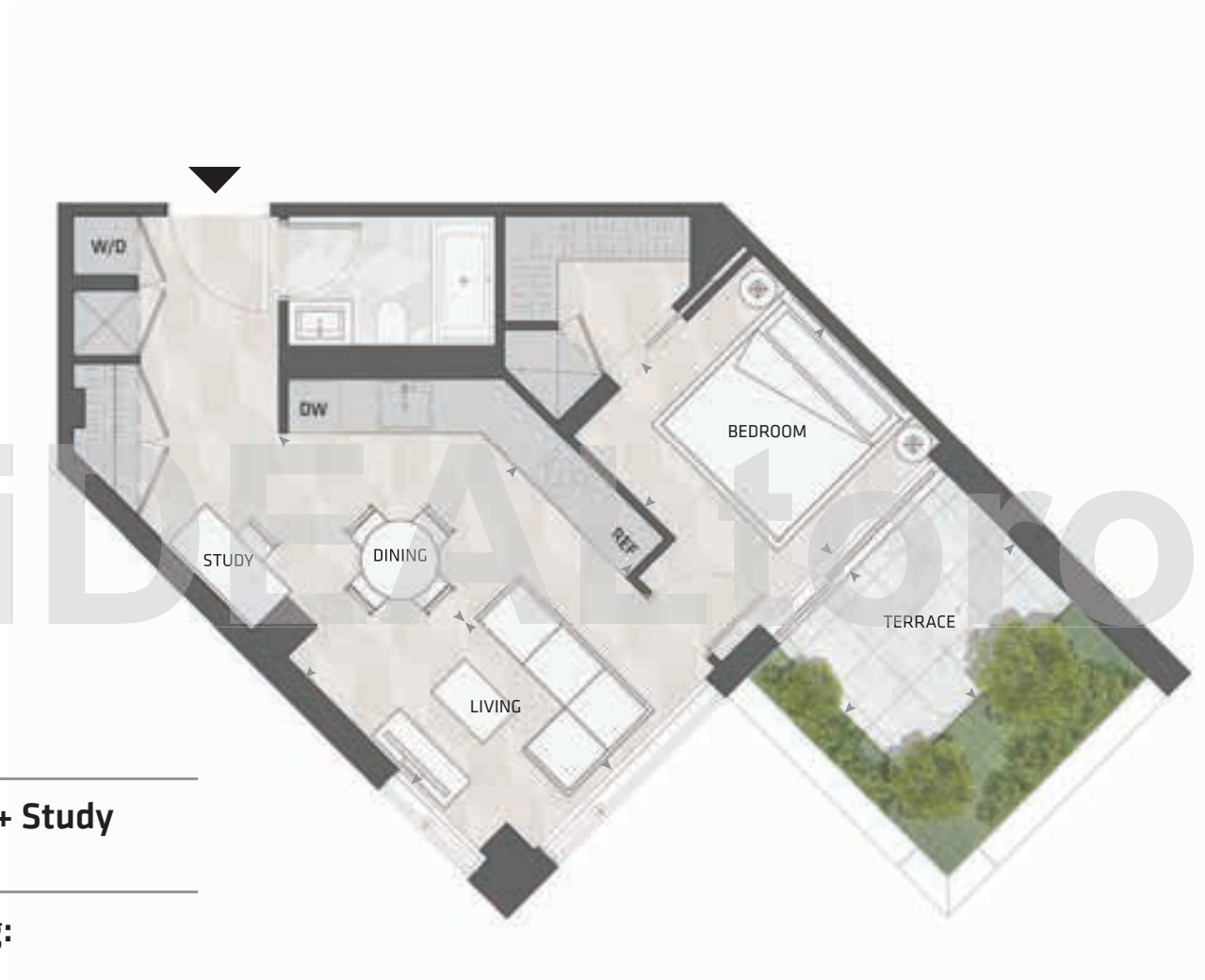

1BD.20A

**1 Bedroom + Study
1 Bathroom**

**Total Living:
730 ft²**

Interior Living:
587 ft²

Exterior Living:
143 ft²

LIVING	12' 0" X 10' 4"
DINING	11' 4" X 8' 2"
BEDROOM	9' 10" X 10' 2"
TERRACE	9' 1" X 6' 8"

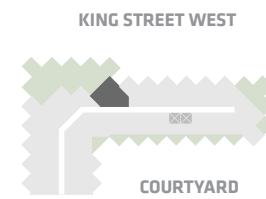

NORTH MOUNTAIN KEYPLAN



All dimensions and specifications are approximate. Certain plans are reverse or mirror image. Balcony square footages are estimated and may vary from that stated. Please see Sales Representative for details. Furniture not included. Refer to key plan for unit location and orientation. E. & O.E.

KING

HOME 809 N



1BD.20B

**1 Bedroom + Study
1 Bathroom**

**Total Living:
736 ft²**

Interior Living:
593 ft²

Exterior Living:
143 ft²

LIVING	11' 1" X 10' 4"
DINING	11' 4" X 8' 2"
BEDROOM	9' 10" X 10' 3"
TERRACE	6' 8" X 9' 1"

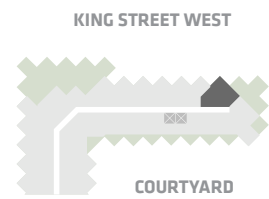

NORTH MOUNTAIN KEYPLAN



All dimensions and specifications are approximate. Certain plans are reverse or mirror image. Balcony square footages are estimated and may vary from that stated. Please see Sales Representative for details. Furniture not included. Refer to key plan for unit location and orientation. E. & O.E.

KING

HOME 1006 N



1BD.72

**1 Bedroom + Study
1 Bathroom**

**Total Living:
1280 ft²**

Interior Living:
850 ft²

Exterior Living:
430 ft²

LIVING	12' 0" x 12' 0"
DINING	11' 7" x 12' 5"
BEDROOM	10' 10" x 11' 10"
TERRACE A	9' 1" x 6' 8"
TERRACE B	6' 8" x 9' 1"

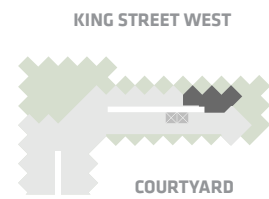

NORTH MOUNTAIN KEYPLAN



All dimensions and specifications are approximate. Certain plans are reverse or mirror image. Balcony square footages are estimated and may vary from that stated. Please see Sales Representative for details. Furniture not included. Refer to key plan for unit location and orientation. E. & O.E.